

PROJECT NO: 1590-14-70

HWY: USH 8

COUNTY: LINCOLN/ONEIDA

CROSS SECTIONS: USH 8

SHEET

E

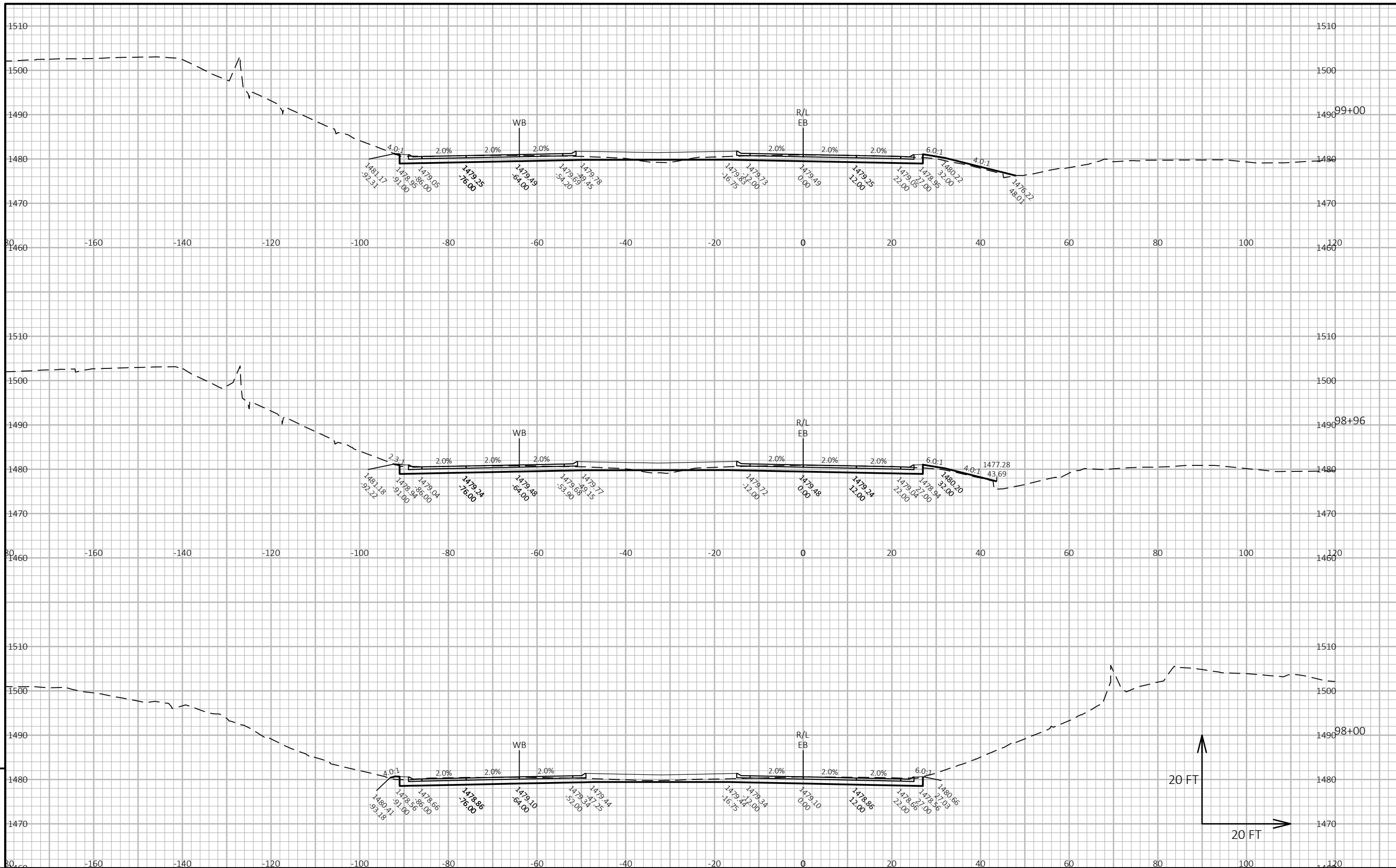

PROJECT NO: 1590-14-70

HWY: USH 8

COUNTY: LINCOLN/ONEIDA

CROSS SECTIONS: USH 8

SHEET

E

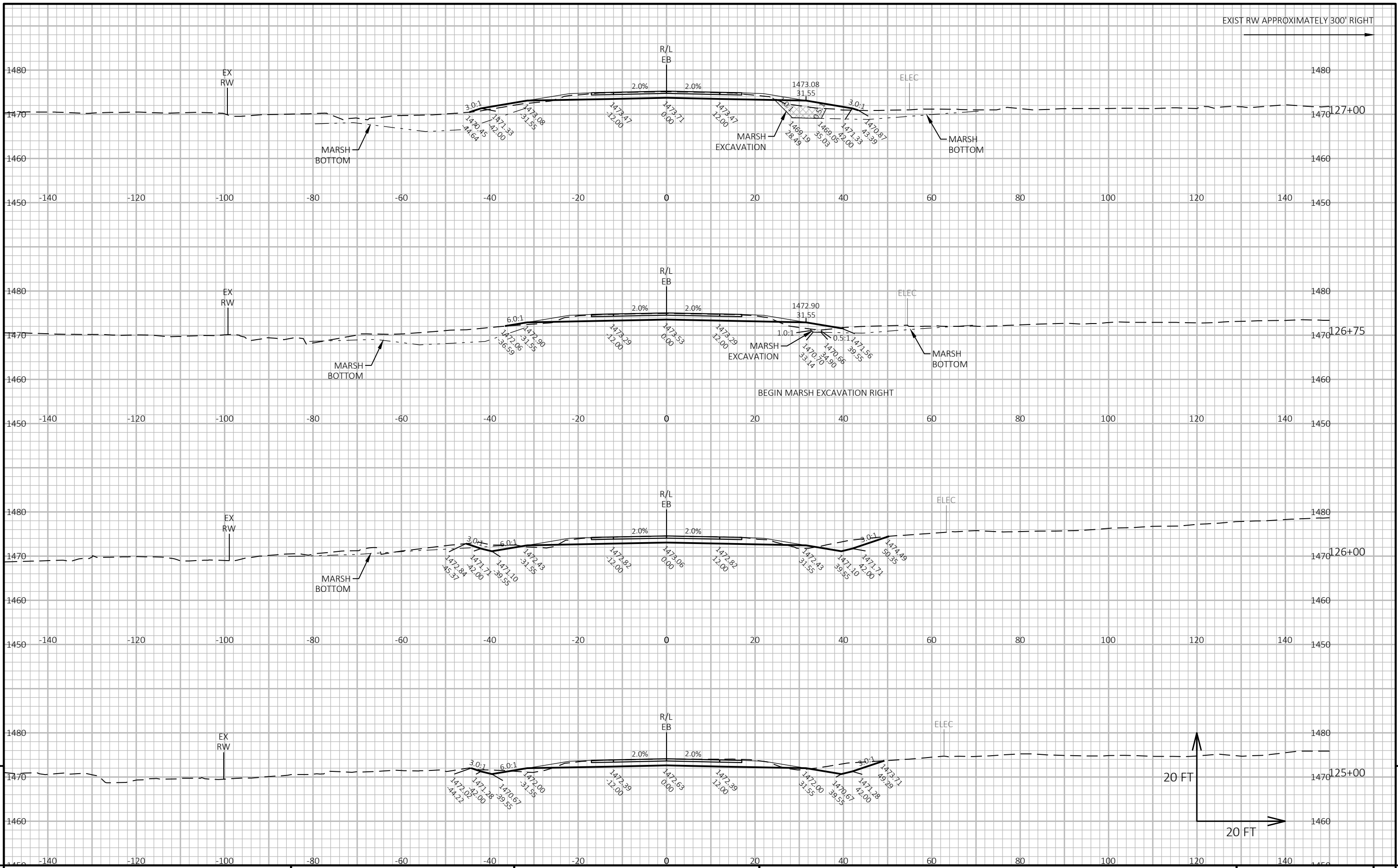

PROJECT NO: 1590-14-70

HWY: USH 8

COUNTY: LINCOLN/ONEIDA

CROSS SECTIONS: USH 8

SHEET

E

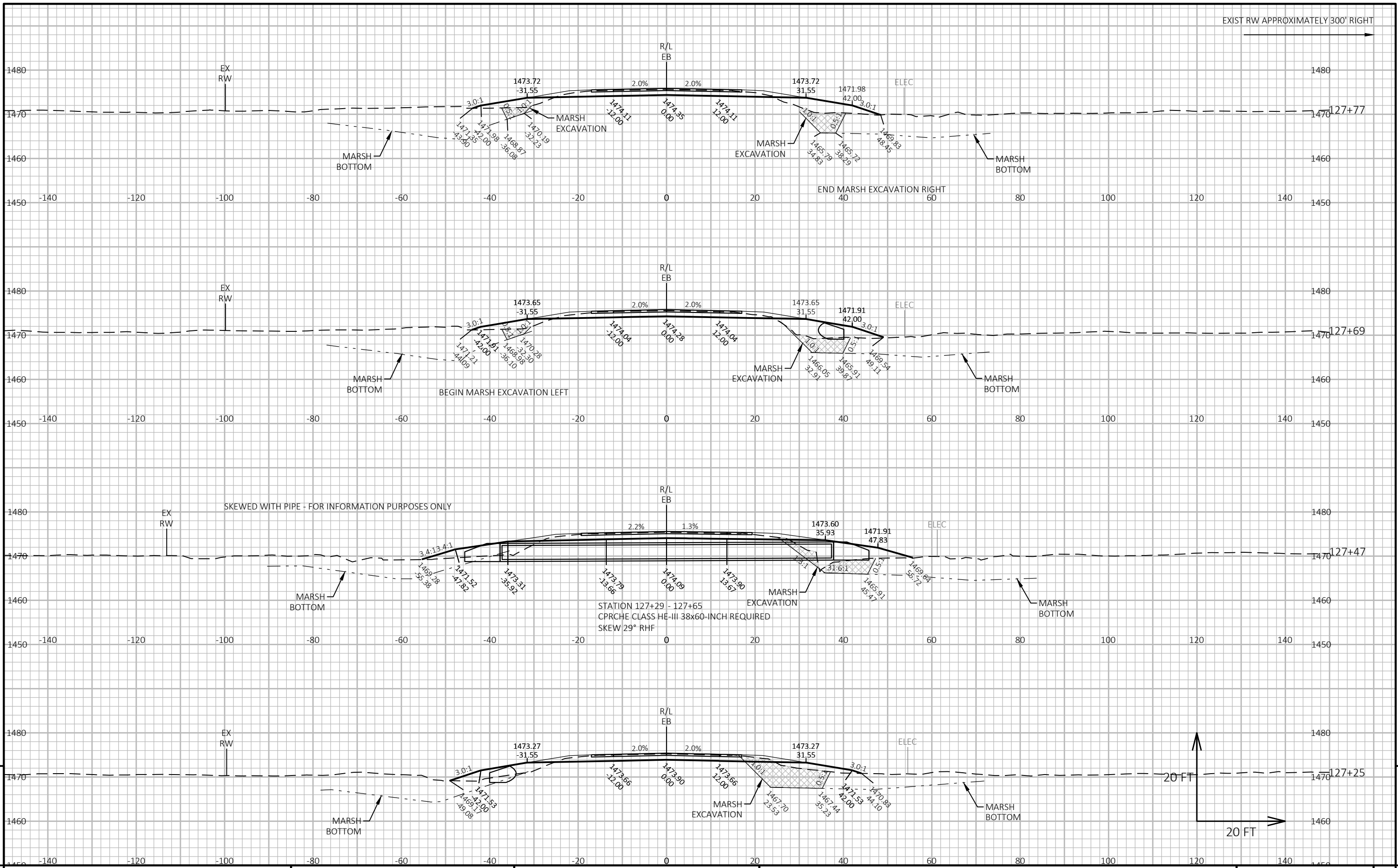

EXIST RW APPROXIMATELY 300' RIGHT

PROJECT NO: 1590-14-70      HWY: USH 8      COUNTY: LINCOLN/ONEIDA      CROSS SECTIONS: USH 8      SHEET      E

FILE NAME : C:\USERS\DOTM9L\ACCDOS\WISDOT\MDU-ACC\PROJECT FILES\C3D\15901400\SHEETS\090201-XS.DWG      PLOT DATE : 8/30/2022 8:59 AM      PLOT BY : LAVIN, MITCHELL L      PLOT NAME :      PLOT SCALE : 1 IN:20 FT HORZ. / 1 IN:20 FT VERT.      WISDOT/CADD SHEET 49

9

9

20 FT

20 FT

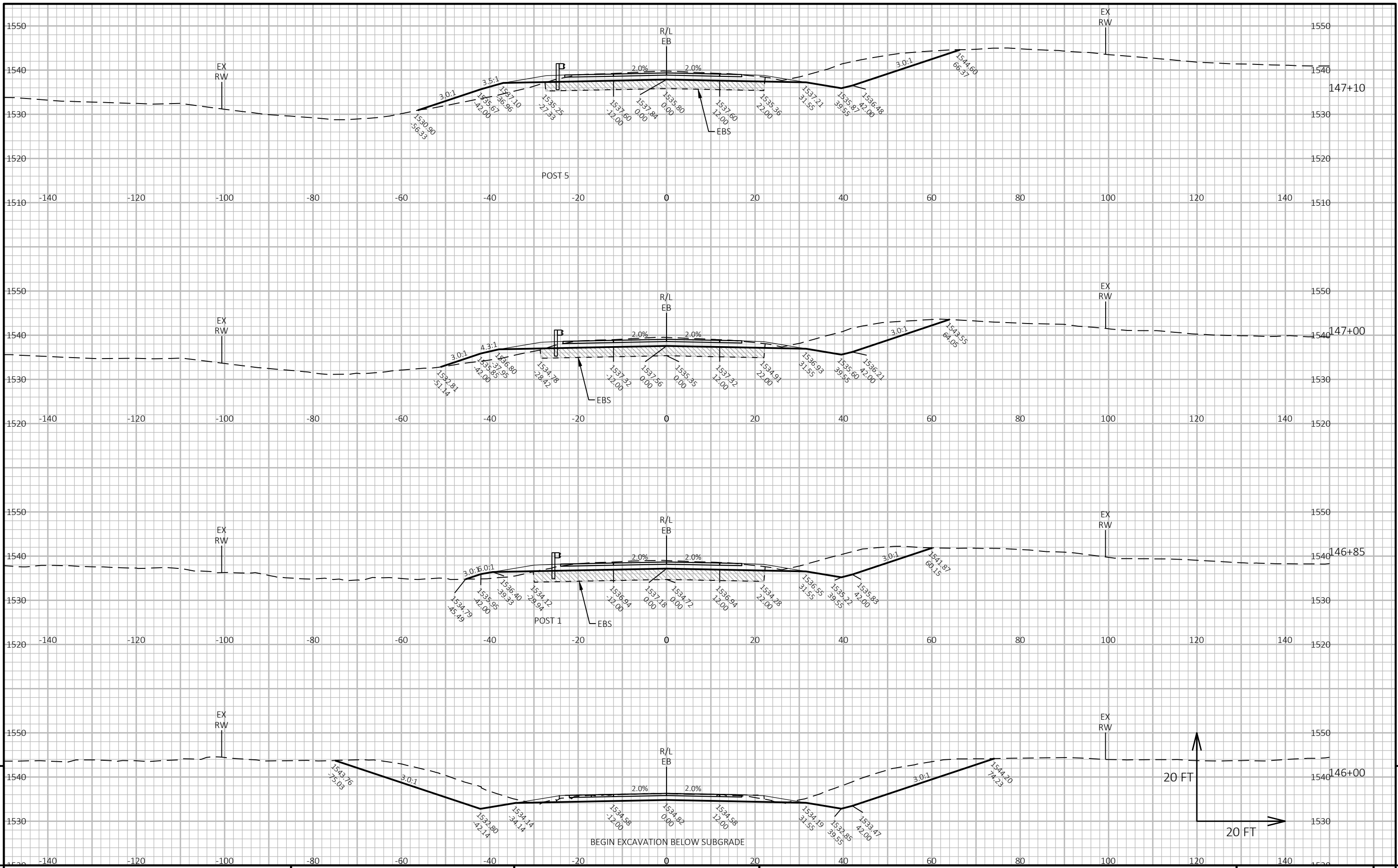

PROJECT NO: 1590-14-70

HWY: USH 8

COUNTY: LINCOLN/ONEIDA

CROSS SECTIONS: USH 8

SHEET

E

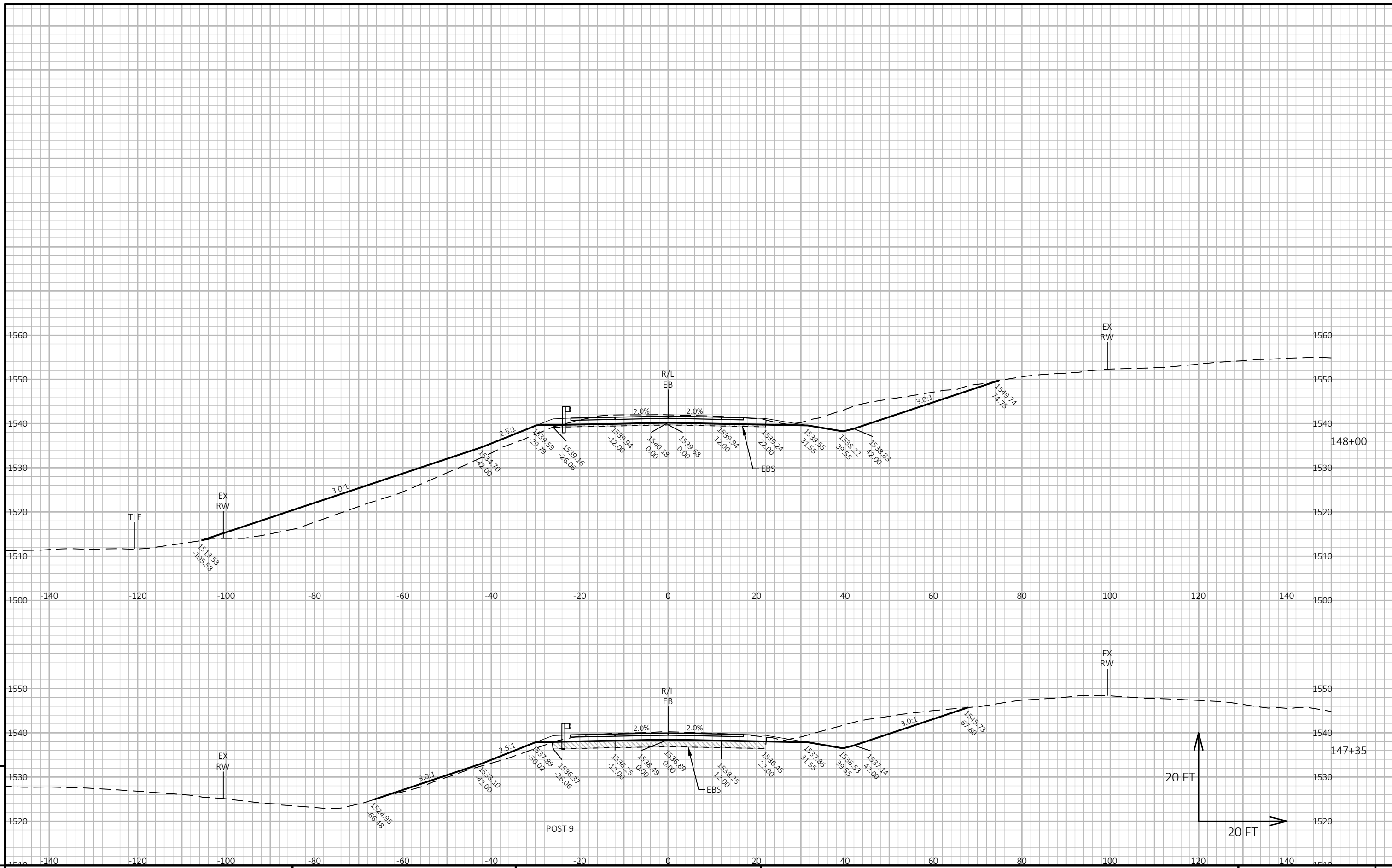

PROJECT NO: 1590-14-70

HWY: USH 8

COUNTY: LINCOLN/ONEIDA

CROSS SECTIONS: USH 8

SHEET

E

EXISTING RW OVER 600' LEFT

EXISTING RW OVER 1000' RIGHT

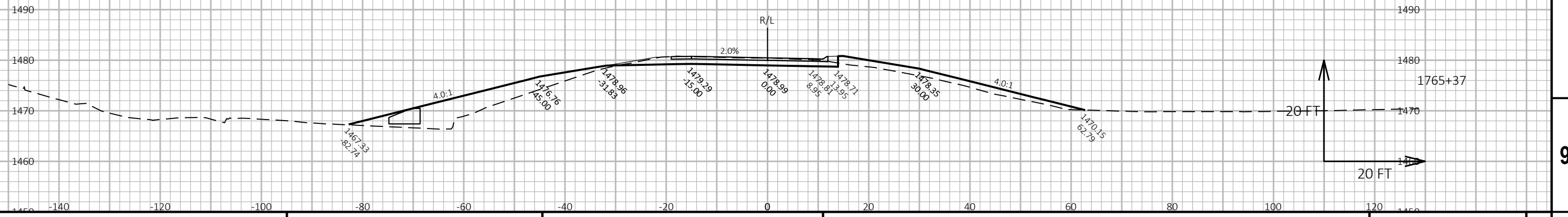
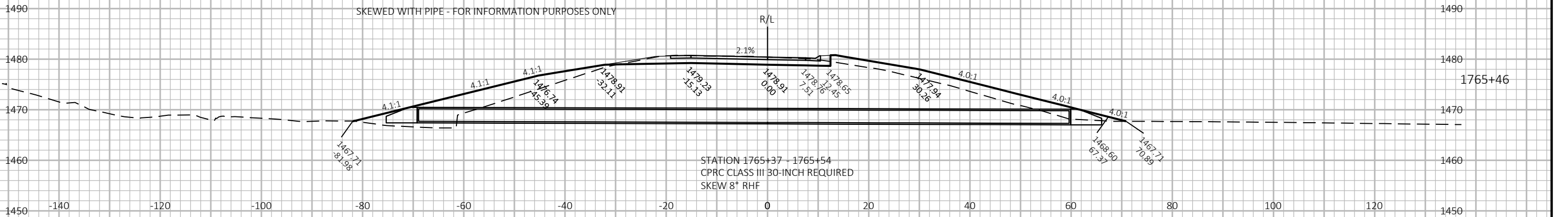
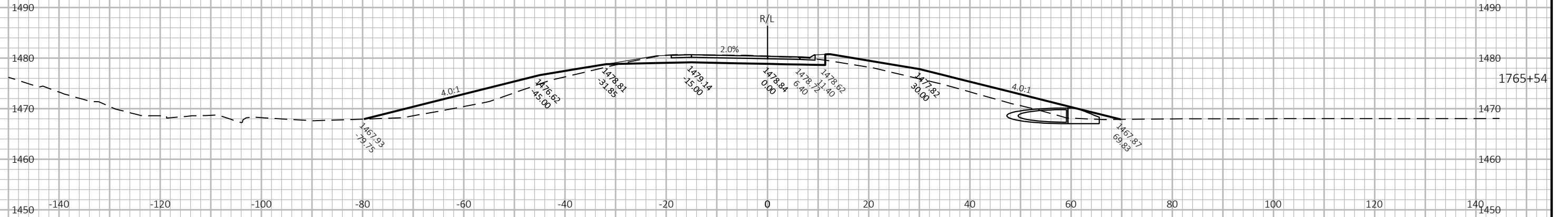

PROJECT NO: 1590-14-70

HWY: USH 8

COUNTY: LINCOLN/ONEIDA

CROSS SECTIONS: RAMP A

SHEET

E