

PROJECT ID: 1170-19-70  
 WITH: 1170-19-71

COUNTY: VILAS

STATE OF WISCONSIN  
 DEPARTMENT OF TRANSPORTATION

PLAN OF PROPOSED IMPROVEMENT

MINOCQUA - MANITOWISH

3RD AVE TO N JCT STH 70

USH 51  
 VILAS

MINOCQUA - MANITOWISH

3RD AVE TO N JCT STH 70 SANITARY AND WATER UTILITIES

USH 51  
 VILAS

STATE PROJECT	FEDERAL PROJECT	
	PROJECT	CONTRACT
1170-19-70		
1170-19-71		

ORDER OF SHEETS

Section No.	Title
1	Typical Sections and Details
2	Estimate of Quantities
3	Miscellaneous Quantities
4	Right of Way Plat
5	Plan and Profile
6	Standard Detail Drawings
7	Sign Plates
8	Structure Plans
9	Computer Earthwork Data
9	Cross Sections

TOTAL SHEETS =

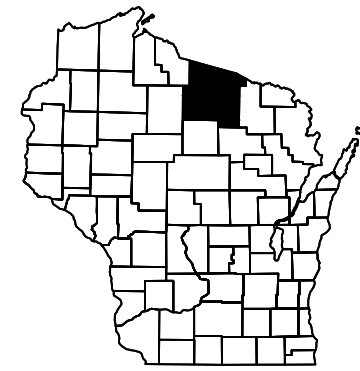

DESIGN DESIGNATION 1170-19-00

A.A.D.T.	2012	=	13,200 - 15,300
A.A.D.T.	2036	=	18,400 - 19,900
D.H.V.		=	2,098 - 2,268
D.D.		=	61/39
T.		=	13.2%
DESIGN SPEED		=	35 MPH/ 50MPH
ESALS		=	5,482,300

CONVENTIONAL SYMBOLS

PLAN	PROFILE
CORPORATE LIMITS	GRADE LINE
PROPERTY LINE	ORIGINAL GROUND
LOT LINE	MARSH OR ROCK PROFILE (To be noted as such)
LIMITED HIGHWAY EASEMENT	SPECIAL DITCH
EXISTING RIGHT OF WAY	GRADE ELEVATION
PROPOSED OR NEW R/W LINE	CULVERT (Profile View)
SLOPE INTERCEPT	UTILITIES
REFERENCE LINE	ELECTRIC
EXISTING CULVERT	FIBER OPTIC
PROPOSED CULVERT (Box or Pipe)	GAS
COMBUSTIBLE FLUIDS	SANITARY SEWER
	STORM SEWER
	TELEPHONE
MARSH AREA	WATER
	UTILITY PEDESTAL
	POWER POLE
WOODED OR SHRUB AREA	TELEPHONE POLE

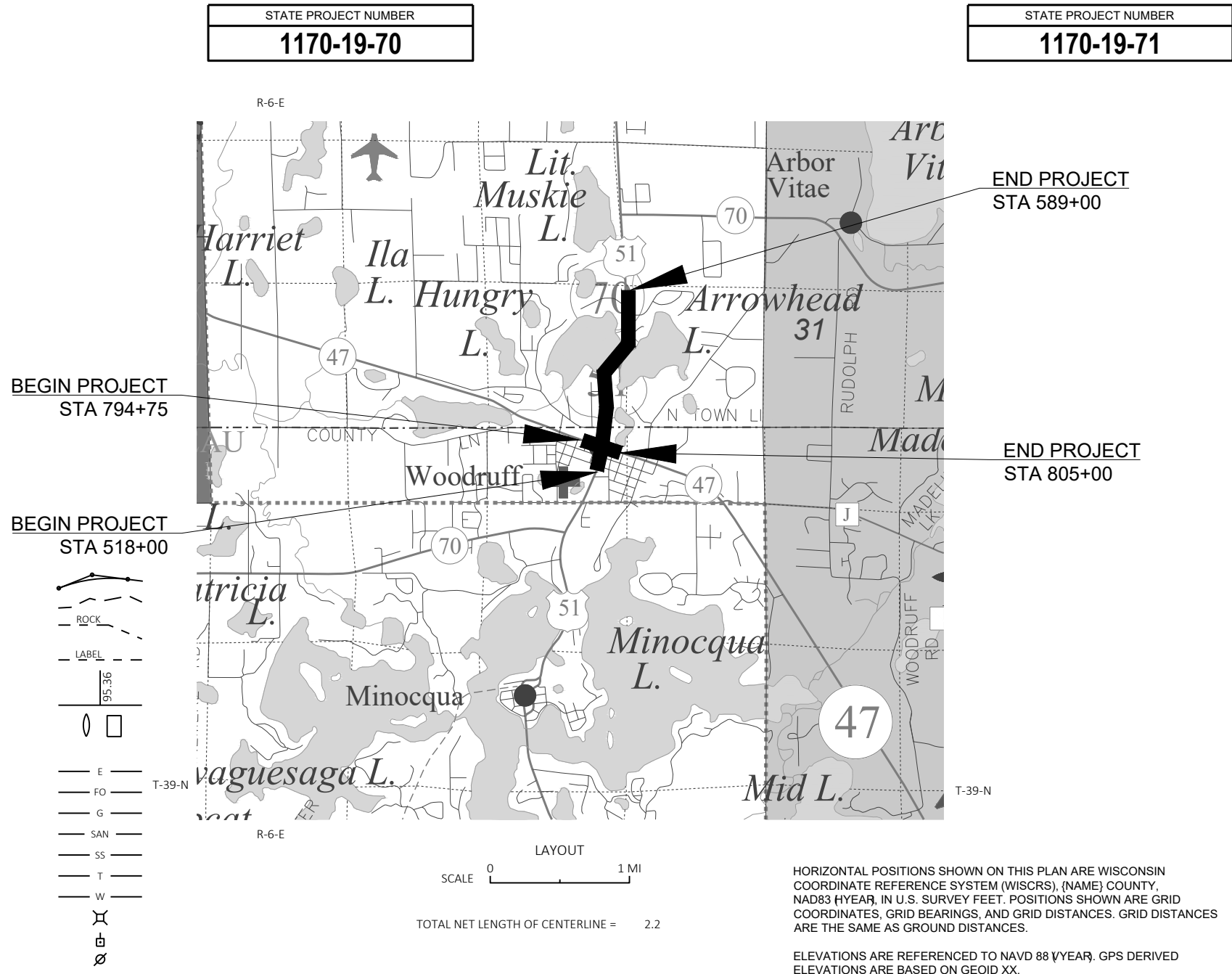

STATE OF WISCONSIN  
 DEPARTMENT OF TRANSPORTATION

PREPARED BY

Surveyor	SURVEYOR
Designer	DESIGNER
Project Manager	PROJECT MANAGER
Regional Examiner	REGIONAL EXAMINER
Regional Supervisor	REGIONAL SUPERVISOR

APPROVED FOR THE DEPARTMENT

DATE: \_\_\_\_\_ (Signature)

PROJECT ID: 1170-19-70  
 WITH: 1170-19-71

COUNTY: VILAS

STATE OF WISCONSIN  
 DEPARTMENT OF TRANSPORTATION  
 PLAN OF PROPOSED IMPROVEMENT

STATE PROJECT	FEDERAL PROJECT	
	PROJECT	CONTRACT
1170-19-70		
1170-19-71		

ORDER OF SHEETS

Section No.	Title
1	Typical Sections and Details
2	Estimate of Quantities
3	Miscellaneous Quantities
4	Right of Way Plat
5	Plan and Profile
6	Standard Detail Drawings
7	Sign Plates
8	Structure Plans
9	Computer Earthwork Data
9	Cross Sections

TOTAL SHEETS =



DESIGN DESIGNATION 1170-19-00

A.A.D.T.	2012	=	13,200 - 15,300
A.A.D.T.	2036	=	18,400 - 19,900
D.H.V.		=	2,098 - 2,268
D.D.		=	61/39
T.		=	13.2%
DESIGN SPEED		=	35 MPH/50 MPH
ESALS		=	5,482,300

CONVENTIONAL SYMBOLS

PLAN	PROFILE
CORPORATE LIMITS	GRADE LINE
PROPERTY LINE	ORIGINAL GROUND
LOT LINE	MARSH OR ROCK PROFILE (To be noted as such)
LIMITED HIGHWAY EASEMENT	SPECIAL DITCH
EXISTING RIGHT OF WAY	GRADE ELEVATION
PROPOSED OR NEW R/W LINE	CULVERT (Profile View)
SLOPE INTERCEPT	UTILITIES
REFERENCE LINE	ELECTRIC
EXISTING CULVERT	FIBER OPTIC
PROPOSED CULVERT (Box or Pipe)	GAS
COMBUSTIBLE FLUIDS	SANITARY SEWER
MARSH AREA	STORM SEWER
WOODED OR SHRUB AREA	TELEPHONE
	WATER
	UTILITY PEDESTAL
	POWER POLE
	TELEPHONE POLE

MINOCQUA - MANITOWISH  
 3RD AVE TO N JCT STH 70  
 USH 51  
 VILAS

MINOCQUA - MANITOWISH  
 3RD AVE TO N JCT STH 70 SANITARY AND WATER UTILITIES  
 USH 51  
 VILAS

STATE PROJECT NUMBER  
 1170-19-70

STATE PROJECT NUMBER  
 1170-19-71

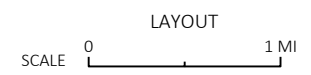
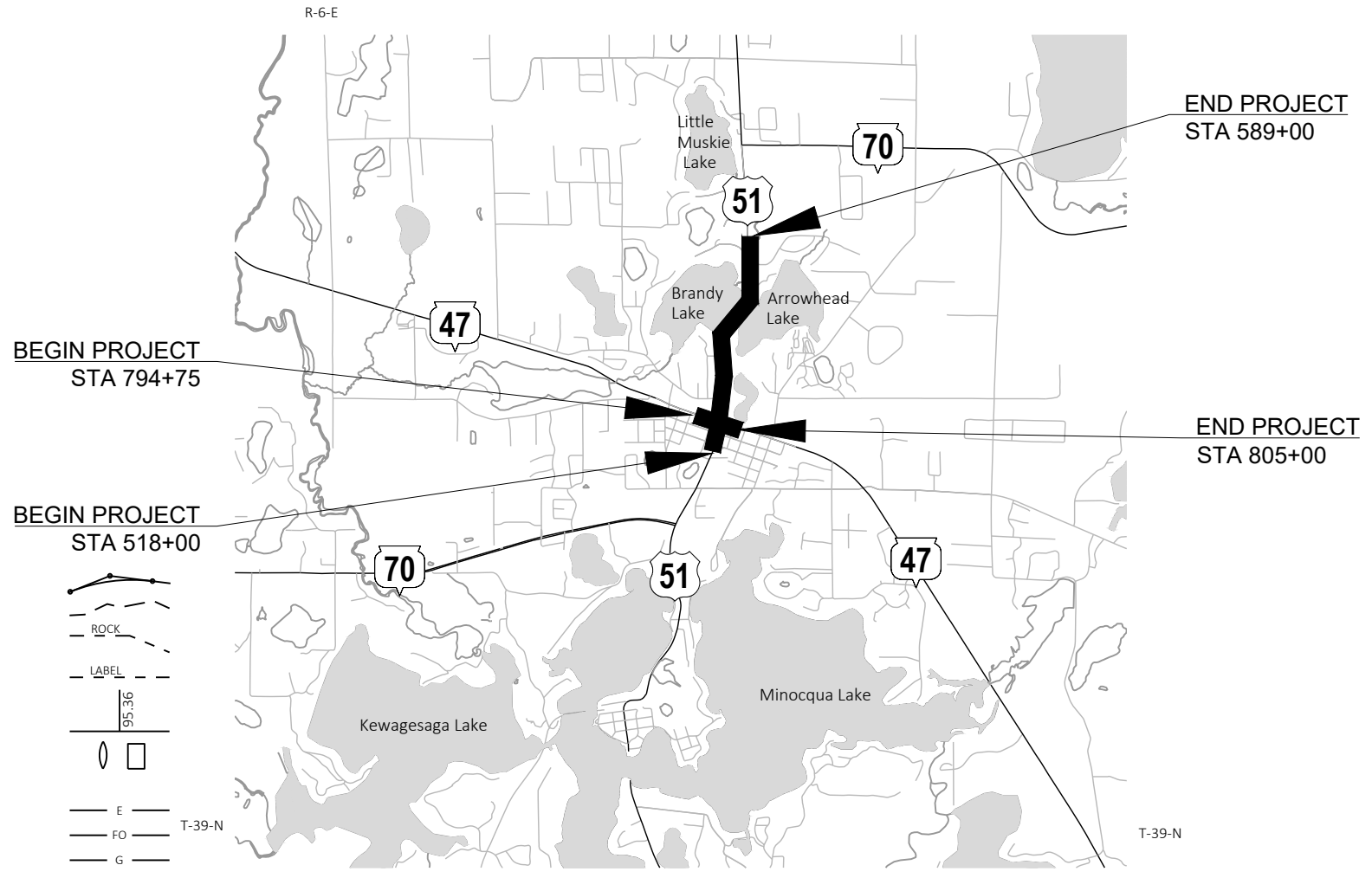

TOTAL NET LENGTH OF CENTERLINE = 2.2

HORIZONTAL POSITIONS SHOWN ON THIS PLAN ARE WISCONSIN COORDINATE REFERENCE SYSTEM (WISCRS), (NAME) COUNTY, NAD83 HYEAR, IN U.S. SURVEY FEET. POSITIONS SHOWN ARE GRID COORDINATES, GRID BEARINGS, AND GRID DISTANCES. GRID DISTANCES ARE THE SAME AS GROUND DISTANCES.

ELEVATIONS ARE REFERENCED TO NAVD 88 (YEAR). GPS DERIVED ELEVATIONS ARE BASED ON GEOID XX.

STATE OF WISCONSIN  
 DEPARTMENT OF TRANSPORTATION

PREPARED BY	SURVEYOR
Surveyor	DESIGNER
Designer	PROJECT MANAGER
Project Manager	REGIONAL EXAMINER
Regional Examiner	REGIONAL SUPERVISOR
Regional Supervisor	

APPROVED FOR THE DEPARTMENT

DATE: \_\_\_\_\_ (Signature)

E